



**Trails – Nature Play – Education – Ecology – Commerce**

# Hensel Park: Renewal of a Historic Public Space

A proposal presented by the Hensel Park Committee 2023

# Acknowledgements

## Hensel Park Committee Members

- Clint Cooper (Executive Director, System Real Estate Office)
- Chanam Lee (Professor and PhD Coordinator, Landscape Architecture and Urban Planning)
- Galen Newman (Professor and Head, Landscape Architecture and Urban Planning)
- Michael Ostrowski (Director, Planning and Development Services, College Station)
- Jennifer Prochazka (Assistant City Manager, College Station)
- Dingding Ren (PhD Student and Lecturer, Landscape Architecture and Urban Planning)
- Steve Wright (Director, College Station Parks and Recreation)
- Coby Whitehead (Chief of Staff, Office of the VP of Facilities, Health, Safety and Security)
- David Schmitz (Director, Parks and Recreation Facilities, Bryan)
- Sean Ray (TAMUS System Civil Engineer)
- Greg Hartman (Senior VP and COO, TAMU)
- Scott Shafer (Professor, Recreation, Park and Tourism Sciences)

## Landscape Architecture Students

- Manuel Gomez
- Clayton Daeschner
- Clayton Langseth
- Francisco Garcia
- Juan Reynaga-Villegas
- Mariana Gonzales
- Alexandria Hernandez
- Kristopher Hunter
- Mathew Martinez
- Zachary Garza
- Yeankyong Hahm (Graduate Teaching Assistant)

# Table of Contents



- Introduction
- History of Hensel Park
- Planning Process
- Committee Recommendations
- Concept Plan
- Estimated Cost Phase 1
- Student Work

# Introduction

Established in 1954 Hensel Park was one of the first public parks for Texas A&M University and College Station. It offers more than 50 acres of natural space at the intersection of Texas A&M University, the City of College Station and the City of Bryan. No other location offers such an opportunity to literally and figuratively join these three key entities. Hensel Park will be reborn as a central gathering place for all generations of Aggies and College Station/Bryan residents.

Hensel Park provides an opportunity for Texas A&M University to give residents from across the community access to a wonderful public space. A space that will contribute to the daily health and wellbeing of thousands. Hensel will educate visitors about best practices for sustainable development in an urban environment. It will offer early childhood educational opportunities to students of the Beck Gates and Charlotte Sharp Children Centers. Research on ecological restoration, stormwater management, urban wildlife and other topics can be supported.

Hensel Park is ideally located to spur new economic activity through food and beverage, retail, and housing developments. The park will serve as a catalyst, bringing a new vitality to South College Avenue where it connects to Bryan's Midtown development. There are already thousands of students and other residents living within a 5-10 minute walk of Hensel Park. Demand for park space in the Northgate area will continue to increase as new high rise housing units densify its neighborhoods.

# Introduction

Over the past 20 years a number of classes in different departments on campus have examined Hensel Park and considered its value as an educational, recreational and tourism resource. Different administrations have considered investing in Hensel Park but no significant changes have occurred. Hensel Park's potential has greatly increased as the populations of Texas A&M and the surrounding community have grown.

This document outlines a process that took place between August of 2022 and August of 2023. The purpose being to gather a group of representatives, including students, from TAMU and the two cities to again consider the park's value and offer a plan for the renewal of this exceptional resource.

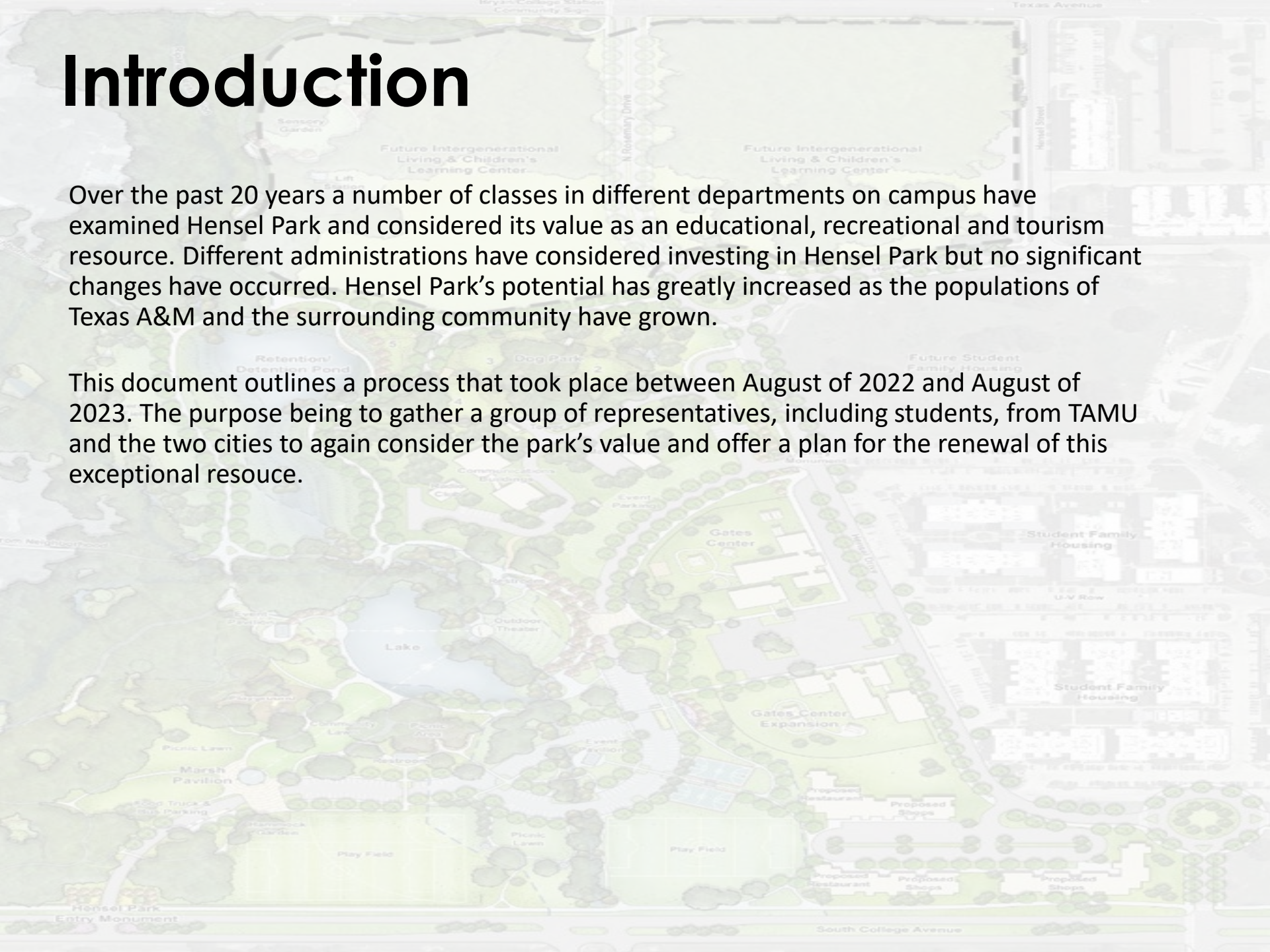

# History of Hensel Park



F.W. "Fritz" Hensel '07

Marsh's Lift Shape pavilion remains in the park

- 1890s:** The property was dedicated to A&M College for practicing the operation of motorized farm equipment
- 1908:** F.W. Fritz Hensel, class of 1907, was appointed the first Landscape Architect of Texas A&M College
- 1926:** Mr. Hensel organized and was the first chair of the Landscape Arts Department
- 1954:** The park is established as the first park for Texas A&M and second for College Station. It is named in honor of Fritz Hensel
- 1964:** The historic lift shape design invented and first erected in Hensel Park by James Marsh '51, was featured at the World's Fair. Marsh was the first head of Construction Science at TAMC
- 1955-1980s:** Hensel Park was used regularly by student organizations, university departments, church groups and individuals for social gatherings, sporting events, bird watching, picnicing and many other activities
- 1990s-2000s:** Hensel Park fell into disrepair, use waned and the park acquired a negative vibe for many people

# Planning Process 2022-23

- A Hensel Park Committee formed in August of 2022 meeting three times during the fall 2022 term. The committee developed detailed input about their vision for the park and specific facilities to support the vision. (Appendix\_\_)
- At the Board of Regents November 2022 meeting, Regents gave approval to proceed with the development of concepts for the redevelopment of Hensel Park.
- Using input developed by the Hensel Park Committee, Dr. Chanam Lee's senior studio class (Landscape Architecture) worked on Hensel Park concepts through the spring 2023 term.
- Final presentations of park concepts were made by three student teams in April of 2023. Presentations were held at College Station's City Hall. Attendees included the Hensel Park Committee, Texas A&M Administrators, College Station City Council members, College Station staff members and interested citizens.
- The Hensel Park Committee held a meeting in mid-May to review student presentations and develop final recommendations

## Committee Input

Early in the process the 11 members of the Hensel Park Committee were asked about their vision for Hensel Park and program elements that would support the vision.

### Summary responses on a vision for the park.

- Connect TAMU, College Station and Bryan
- Be unique in the community
- Be largely natural in feel or character
- Offer multigenerational recreation opportunities
- Support adjacent economic development

### Summary responses on program elements.

- Trails – a multi-use trail system offering different experiences; connections to surrounding land uses
- Playground – accessible/inclusive; natural play elements; a unique destination
- Water feature(s) – lake, creek, wetland (integrate retention/detention)
- Open play area(s)
- Event space/venue
- Specific sport fields and/or courts (e.g., soccer, basketball, pickleball)

# 11 Recommendations

1. Maintain the natural feel of the park.
2. Create an exemplary sustainable landscape.
3. Implement a safe and enjoyable trail system that provides distance, choice and connections to neighbors.
4. Offer nature-themed play that is accessible and inclusive for children and adults.
5. Provide open turf fields for flexible play and events.
6. Provide specific active recreational use areas.
7. Offer passive recreational areas for relaxation and mental restoration.
8. Develop a retention/detention wetland area.
9. Remove the berm along South College.
10. Make the historic “Lift Shape” pavilion a key feature of the park.
11. Encourage adjacent developments to provide a direct connection to Hensel Park.

**Maintain the natural feel of Hensel Park.**  
Committee members and students felt that Hensel should provide a nature-based experience, a respite from urban surroundings.



**Create an exemplary sustainable landscape.** Teaching, education and research can all be enhanced by creating a landscape that, for example, shows how a wetland detention facility can manage and filter stormwater while providing wildlife habitat. Parking lots and other traditionally paved surfaces can be constructed of pervious materials to reduce runoff and promote infiltration.

Plant native vegetation that requires little water while also attracting birds, butterflies. Plant native grasses found on the region's historic post oak savannas. Balancing safety concerns, employ minimal maintenance (e.g., mowing, trimming) regimes that create "wildscapes" in some areas of the park. Employ used cargo containers to create infrastructure like restrooms or a visitor center.

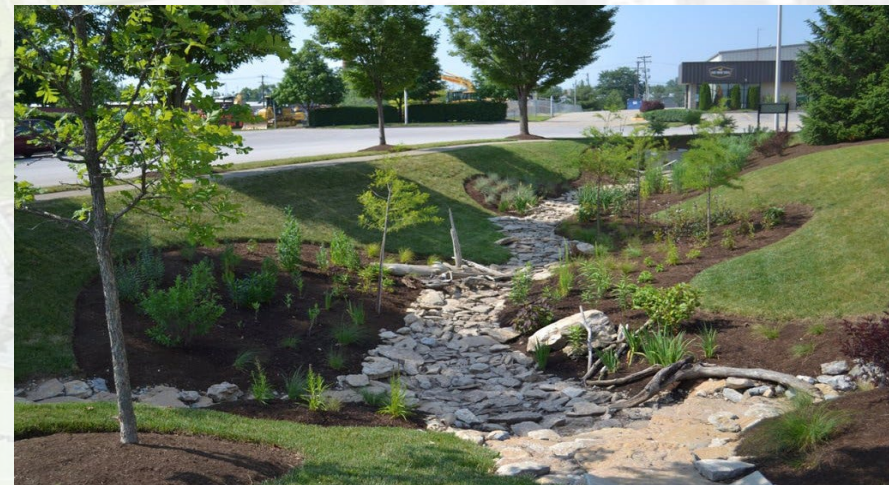
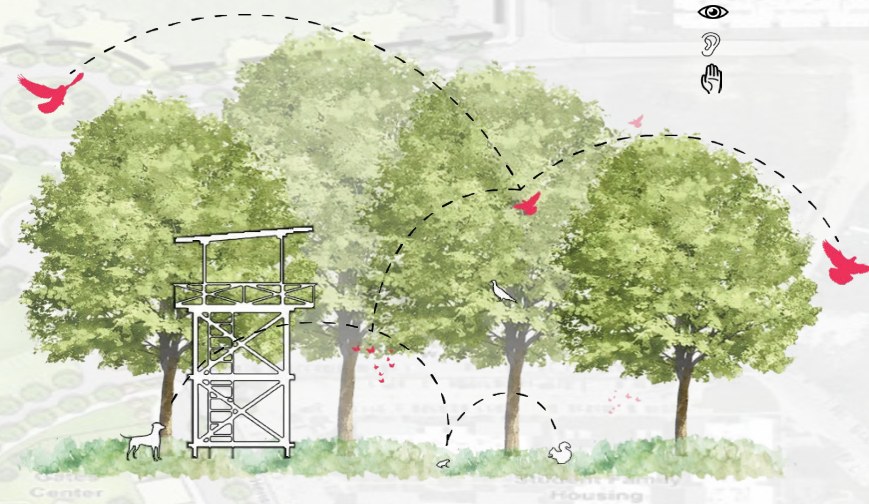

Hensel Park  
Entry Monument

South College Avenue

**Implement a safe and enjoyable trail system that provides distance and choice.** No park in our urban area offers a well-developed multiuse trail system. Hensel Park has enough acreage to implement a trail system that offers different trail treads (hard to soft, wide to narrow), are long, feel safe and are easy to navigate. Choices of trail types allow different walking and bicycling experiences through and around the park. Trails should connect to the Gates and Sharp early childhood education centers, adjacent neighborhoods, South College and Texas Avenues.



Trail Types

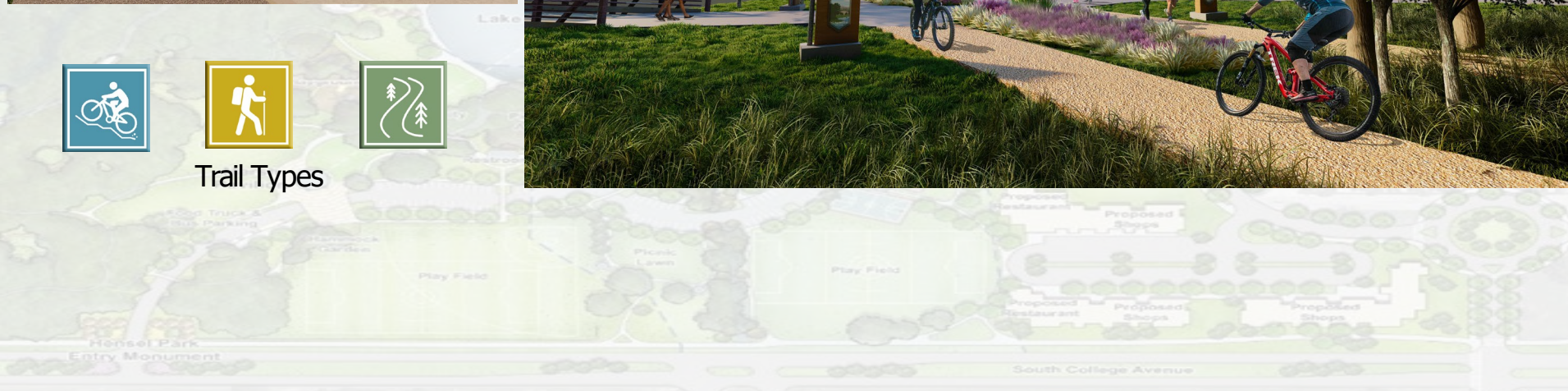

**Offer a nature themed playground that is accessible and inclusive for children and adults.** No public park in the region offers play based around natural elements of rock and wood. Elements that suggest wilderness adventure including forms that reflect interesting plants and animals native to our region.



Hensel Park  
Entry Monument

South College Avenue

**Provide open turf fields for flexible play and events.**

Hensel Park currently has two large open spaces that should be maintained for “pick-up game” play opportunities and the occasional hosting of events. One of these spaces along South College would become openly visible to passing automobile traffic encouraging new visitation. These spaces might include TAMU turf grasses that are being researched for low water use, resilience to drought and recreational use.



**Provide specific active recreational use areas.** These might include hard courts for basketball, pickleball, futsal or a disc golf course. These should be zones away from areas that provide quieter more passive nature-based experiences.



**Remove the berm along South College.** Visual access to the park from adjacent roadways (especially South College) should be improved by removing or redesigning the berm. The berm constructed along South College was intended to help separate the park and create a feeling of escape, but it also restricts visual access inadvertently creating a less safe feel with fewer “eyes on” the park.



**EXISTING CONDITIONS**



**PROPOSED DESIGN**



**Make the historic “Lift Shape” pavilion a key feature of the park.** Interesting ideas developed by student groups and others should be considered. The pavilion could become a central attraction for the display of Aggie culture, art or history. The pavilion’s unusual form makes it an ideal vehicle for integrating art into the park experience.



**Encourage adjacent commercial development well connected to Hensel Park.** Commercial (e.g., retail and restaurants) should be developed along the east side of South College Avenue with good visual and physical connectivity to Hensel Park. Connectivity to the park would offer unique shopping and dining experiences

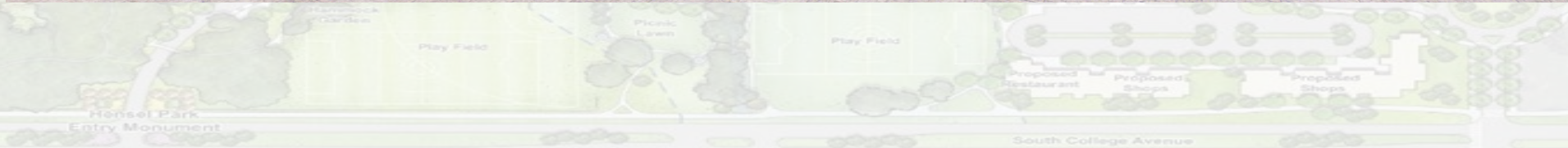

# Concept plan

## Phases

- ① Dome garden
- ② Children play
- ③ Adventure zone
- ④ Multiuse trail
- ⑤ Bike only trail
- ⑥ Detention pond

- ⑦ Active zone

- ⑧ Commercial center
- ⑨ Container center
- ⑩ SCC



Hensel Park  
Entry Monument

South College Avenue



# Estimated Costs Phase 1

- \$2.5 million Trails – 2 miles multiuse dual tread concrete and crushed stone, .5 miles pedestrian only educational loop tread crushed stone, 1 mile mtn bike specific tread natural surface
  - \$700,000 Active Play – nature based children's play, bike playground, adult area
  - \$750,000 Stormwater Mgt. – retention/wetland
  - \$220,000 Wildlife Watching Platform
  - \$450,000 Bridge Structures
  - \$200,000 Lift Shape Pavilion – restoration and art additions
  - \$250,000 New Pavilion – host group events
  - \$200,000 Restroom(s) – Portland Loo or similar
  - \$400,000 Parking – Permeable pavement
  - \$1 million Tree Preservation and New Planting
  - \$225,000 Signage – Entrance and trail wayfinding
  - \$150,000 Fencing – decorative and functional along S. College
  - \$250,000 Furnishings – benches, tables, bicycle racks, other
  - \$800,000 General Site Work
  - \$50,000 Survey Work
  - \$1.14 million A&E Fees @ 14%
- \$9.285 million – Total est. cost

A detailed landscape architectural plan for Hensel Park. The plan shows a large central area with a lake, a retention/detention pond, and various recreational spaces like a dog park, play fields, and picnic areas. There are also several buildings and structures, including a future intergenerational living and children's learning center, a student family housing complex, a gates center, and a community food pantry. The plan is color-coded with different shades of green and blue to represent different zones and features. The text 'Student Work' is overlaid on the plan in a large, black, sans-serif font.

# Student Work

Three student teams developed concepts for Hensel Park. A portion of each team's work is represented in the following pages.

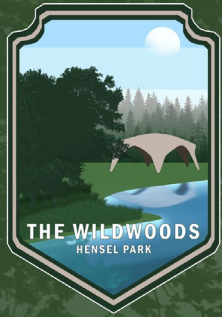

# HENSEL WILD WOODS PARK MASTER PLAN PROPOSAL

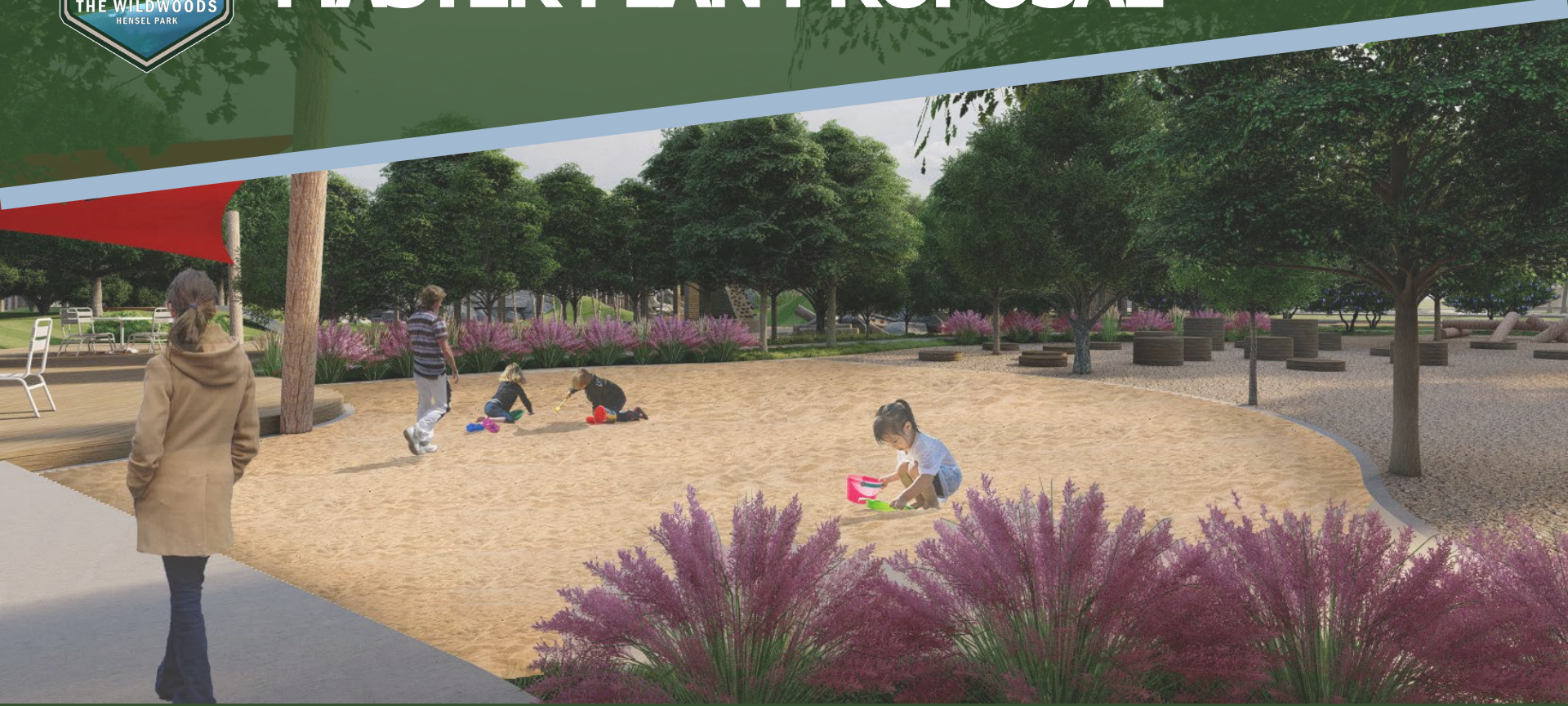

Clayton Langseth  
Clayton Daeschner  
Manuel Gomez

Texas A&M University  
College Station, TX  
LAND-412 April 24, 2023

Place in appendix to show  
Student teams

**E=MC<sup>2</sup>**



**Manuel Gomez '23**  
Focus: Design Programming



**Clayton Daeschner '23**  
Focus: Graphics & Design



**Clayton Langseth '23**  
Focus: AutoCAD & 3D-Modeling

## OUR MISSION

Hensel Park has been a part of the long-standing history of three communities: Texas A&M University, the City of College Station, and the City of Bryan. As the three communities have grown in size and diversity, there has been an increasing need for **natural-based** public open spaces that can support the diverse recreational activities for people of all ages and abilities. Despite the strong potential to serve this role as a central convergence of all three communities, Hensel Park has continued to be **underutilized**.

**Our mission** is to propose design concepts to make the park become a meaningful and attractive outdoor destination that connects members of the three communities with each other and **nature**.

## OUR VISION

Provide a revitalized recreational destination for the three communities and beyond, that promotes the health and well-being of the community members by encouraging active nature-based play, community engagement, and access to nature.

# DESIGN PROGRAMMING ELEMENTS



**MULTI GENERATIONAL UNITY**



**HEALTH & WELLBEING**



**NATURE PLAY**



**EDUCATION & RECREATION**



**URBAN CONNECTIVITY**

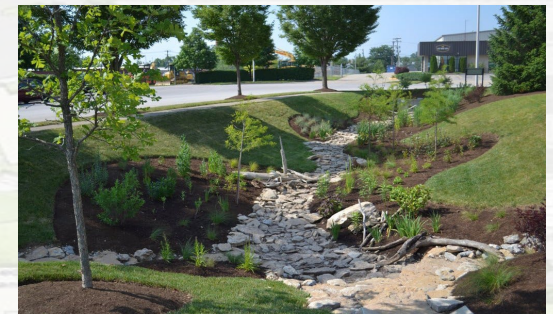

**GREEN INFRASTRUCTURE**

# HENSEL DRIVE AT SOUTH COLLEGE AVE

The new road alignment will create an opportunity a grand entrance into the park.

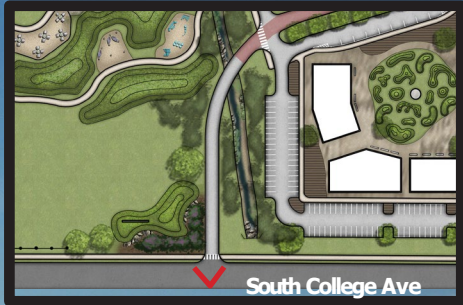

REFORESTATION

ENTRANCE SIGNAGE

EXISTING SIDEWALK

RETAIL SPACE

Hensel Wild Woods Park

Hensel Wild Woods Park

College Station, TX

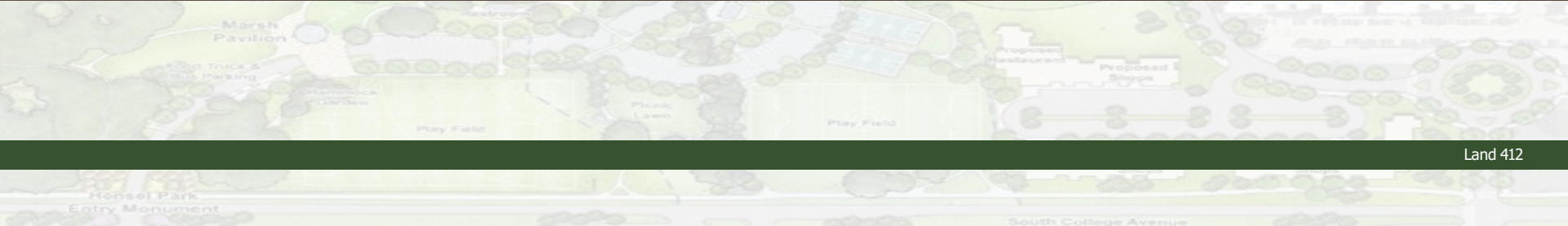

# VISUAL ACCESS INTO HENSEL PARK

Visual access into the park from the street is a great way to attract people into the park.



## EXISTING CONDITIONS

## PROPOSED DESIGN

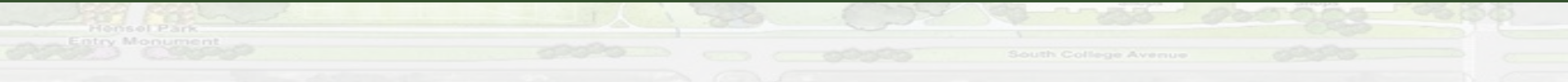

# HENSEL WILD WOODS PARK TRAIL SYSTEM

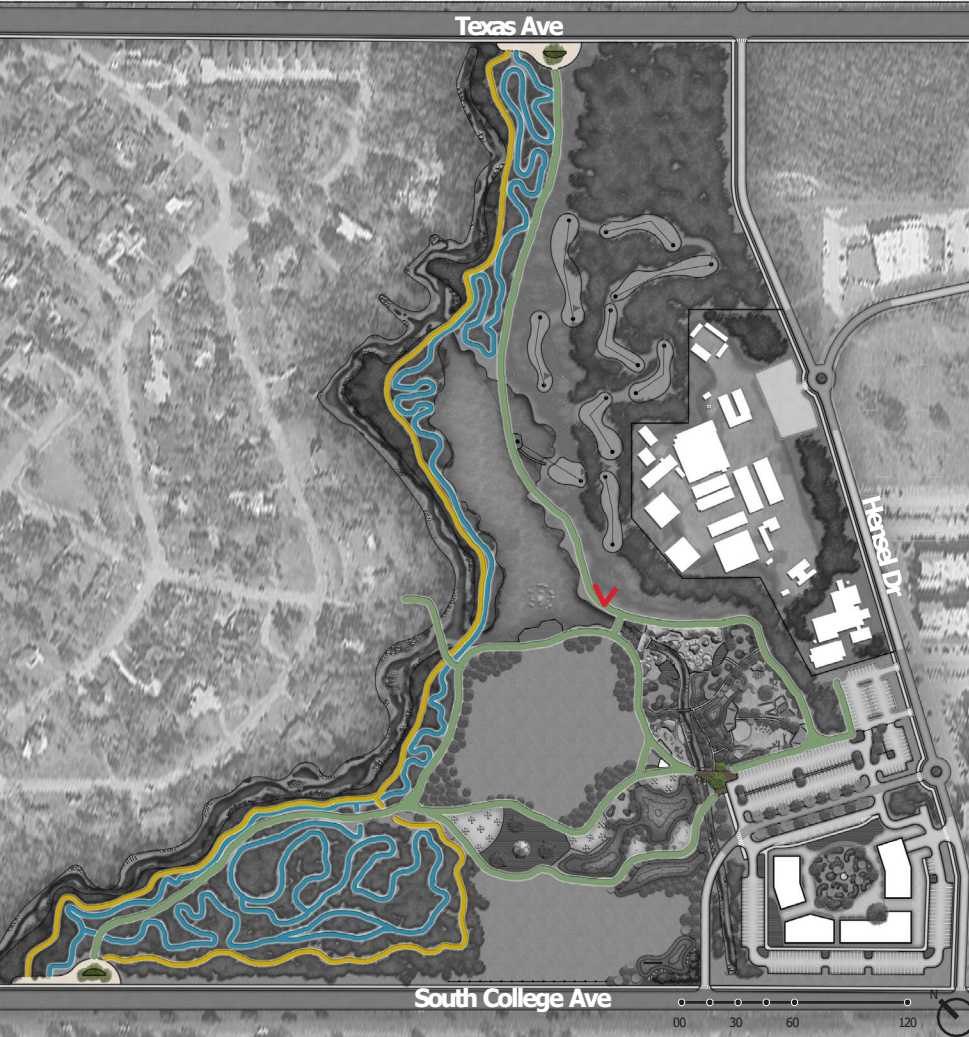

The trail system throughout the park will offer a plethora of **multi-generational** inclusion. Our team is proposing three different types of pedestrian transportation that will improve the **urban connectivity** of the near by neighborhoods. These three proposed systems will serve as an amenities for **health and wellbeing** of the community.



## Trail Distances

- 

Biking Trail Mileage  
2-Mile
- 

Hiking Trail Mileage  
1.5-Mile
- 

Main Trail Mileage  
1-Mile

# WILD WOODS DISC GOLF COURSE

Key Map



Introducing a short, yet challenging 9 hole disc golf course will provide **recreational** opportunities for all ages. The course is strategically placed in the woods to help engage people with **nature play**. This will also give the communities an opportunities to improve their **health and wellness** by engaging in active play amenities.

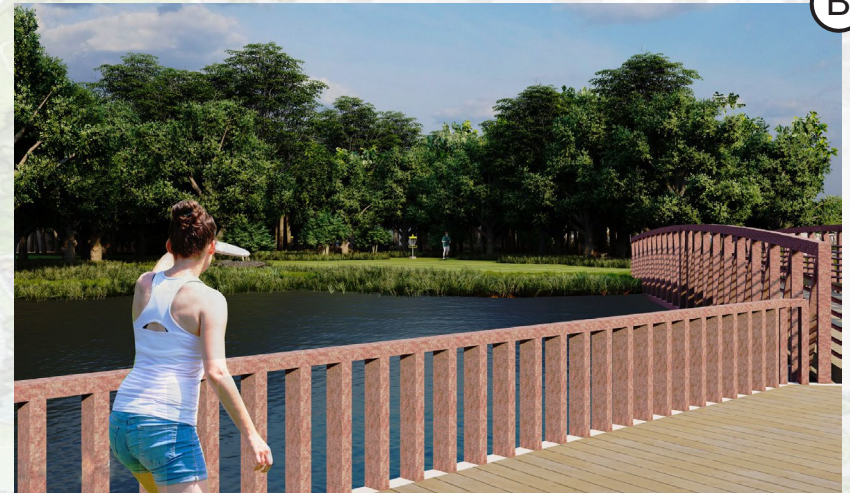

# ECOLOGICAL RESTORATION IN HENSEL WILD WOODS PARK

Ecological Restoration in this site location is required as it was once used as a storage yard for the SCC facilities



RECREATIONAL LAKE

12 MAIN TRAIL

NATIVE PLANTING

REFORESTATION

Hensel Wild Woods Park

NATIVE PLANTING

College Station, TX

# WILD WOODS ADVENTURE ZONE

Adults and Children of all ages can engage in the Wild Woods Adventure Zone, there is no age limit to imagination.



RECYCLED WOOD

MULTI GENERATIONAL  
ACTIVITY

LUSH PLANTING

RECYCLED WOOD

MULTI GENERATIONAL  
ACTIVITY

Hensel Wild  
Woods Park

College  
Station, TX

# THE SHOPS AT WILD WOODS

The shops at Wild Woods, provide an opportunity for people to enjoy small boutique shopping, restaurants, and coffee shops.



PLAY BERMS

SCULPTURE

FOOD TRUCKS

RETAIL SPACE



Hensel Wild Woods Park

College Station, TX

# HENSEL WILD WOODS UNITY CENTER

The Unity Center is the convergence of history from all three local communities, Victoria, Hensel Park, and Texas A&M.

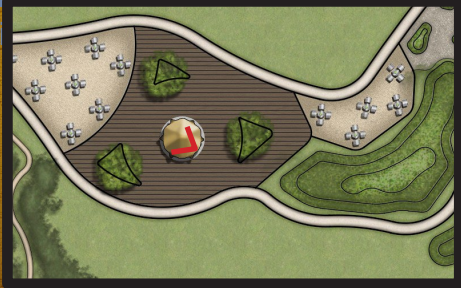

**RESURFACED AND REPAINTED**

**ENCLOSED DOME**

**HISTORIC SCULPTURE**

**HISTORY SIGNAGE**

Hensel Wild Woods Park

**PANEL TRACKS**



**HENSEL PARK**  
 Named after F.W. "Fritz" Hensel  
 Aggie Class of 1907  
 Sculpture  
 To Hensel's first appointed  
 Architect  
 Hensel Park was dedicated in 1954  
 as the first public park  
 invented by  
 James Hensel in 1931  
 Featured in 1939 World's Fair, NY

Original Hensel Park  
 Master Plan  
 -1954-

WELCOME  
 AGGIE

Hensel Park  
 Entry Monument

South College Avenue

# A DAY AT HENSEL WILD WOODS PARK

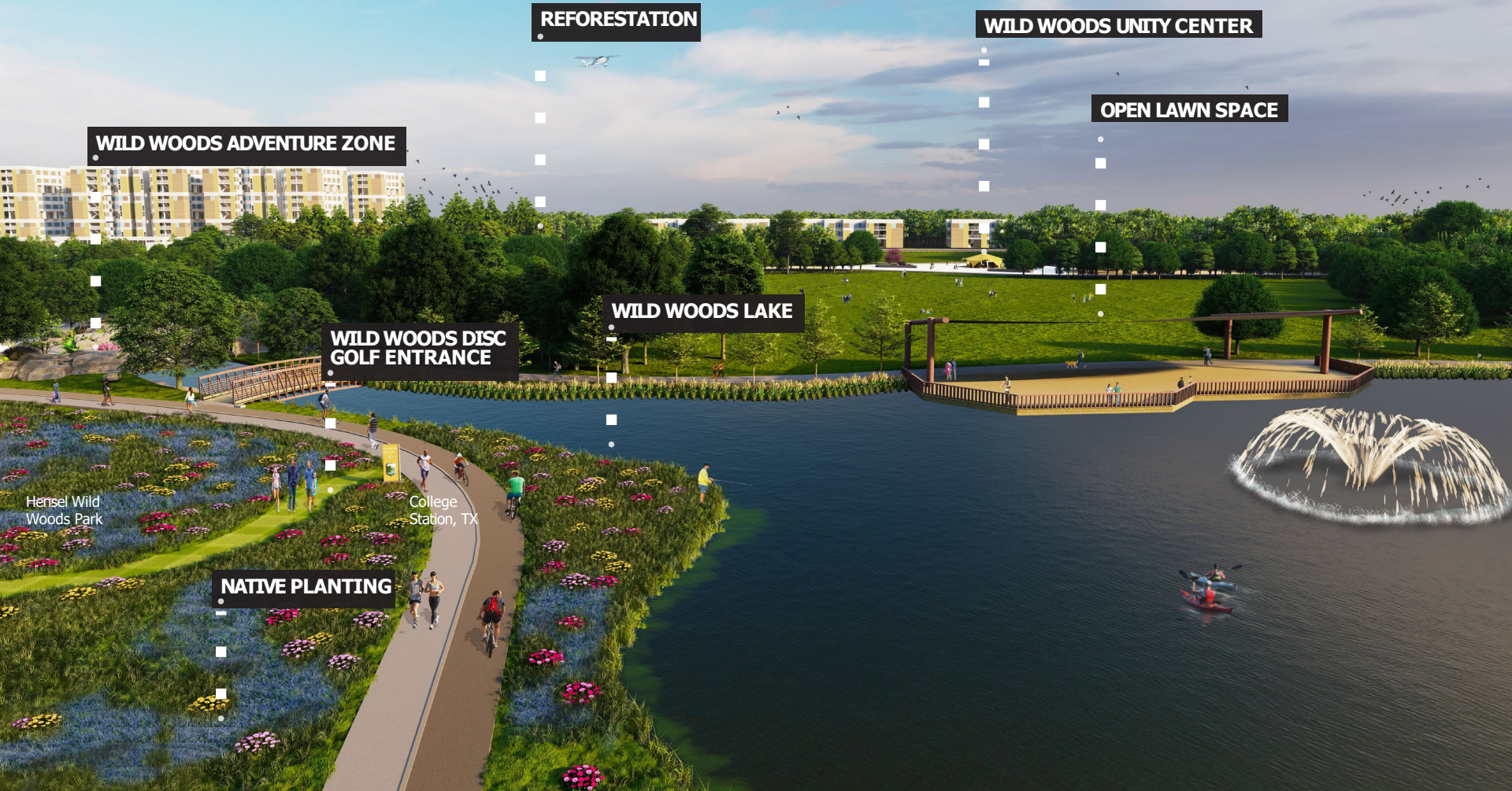

WILD WOODS ADVENTURE ZONE

REFORESTATION

WILD WOODS UNITY CENTER

OPEN LAWN SPACE

WILD WOODS DISC GOLF ENTRANCE

WILD WOODS LAKE

NATIVE PLANTING

Hensel Wild Woods Park

College Station, TX

# HENSEL PARK MASTER PLAN

COLLEGE STATION, TEXAS

2023.04.24

Alexandria Hernandez | Francisco Garcia | Juan Reynaga-Villegas | Mariana Gonzalez

# MISSION: BIOPHILIC PROGRAM FOR A NATURAL LANDMARK

The Biophilic Program identifies Hensel Park as a Natural Connector for the city of College Station and Bryan. The program intends to amplify the park's identity as a natural landmark serving as a connection for communities, infrastructure and wildlife with a landscape that will continue to adapt and regenerate with the passing of time.

Place these slides as appendix  
To show the student teams

## OUR TEAM



**FRANCISCO  
GARCIA**



**JUAN  
REYNAGA-VILLEGAS**



**MARIANA  
GONZALEZ**



**ALEXANDRIA  
HERNANDEZ**

## PARTICIPANTS

### HENSEL PARK COMMITTEE

- Clint Cooper
- Chanam Lee
- Galen Newman
- Michael Ostrowski
- Jennifer Prochazka
- Dingding Ren
- Steve Wright
- Coby Whitehead
- David Schmitz
- Sean Ray
- Greg Hartman
- Scott Shafer

### DESIGN TEAMS

#### TEAM ONE

- Clayton Daeschner
- Clayton Langseth
- Manuel Gomez

#### TEAM TWO

- Alexandria Hernandez
- Francisco Garcia
- Juan Reynaga-Villegas
- Mariana Gonzalez

#### TEAM THREE

- Kristopher Hunter
- Mathew Martinez
- Zach Garza

HENSEL  
PARK

# DESIGNING WITH ELEMENTS IN NATURE



## Organic Forms In Nature

- Use organic shapes found in nature.
- Extend the edge of the site with natural forms.
- Improve the natural experience of the park.



## Biophilic Design In Form

- Have multi-sensory approach.
- Provide a sense of refuge, prospect, or peril.
- Replicate natural ecosystems.



## Landscape Ecology In Design

- Identify the resources of Hensel Park.
- Be conscious of the existing ecological footprint
- Implement sustainable design practice.

# COMMUNITY DEVELOPMENT IN BRYAN & COLLEGE STATION, TX



## BUILDING A COMMUNITY THROUGH HENSEL PARK

### Community Trust:

Holding events in fun outdoor spaces lets the residents of Bryan and College Station to get to know the people in their community and create a fun, safe environment for all ages. Establishing a strong sense of community will inspire people to continue making connections on their own as they enjoy their time living in your town, neighborhood, or apartment complex.

### Charitable Opportunities:

Using gatherings as a chance to hold fundraising events and raise awareness of needs in the community allows everyone to come together for a common cause.

### Park Appreciation:

Hosting community events in Hensel Park is the perfect way to make people feel at home in the outdoors and revive their interest in visiting the community park.

## COMMUNITIES

- Becky Gates Children Center
- Brazos Valley Food Bank
- Brazos Valley Master Gardeners
- Bryan Soccer Club
- College of Agriculture & Life Science
- Farmers market
- North Oakwood, Oak Terrace & Beverly Estates Neighborhood
- Student Organizations
- Texas A&M Cycling Team
- Texas A&M Rec Sports



# PROGRAM DISCUSSIONS

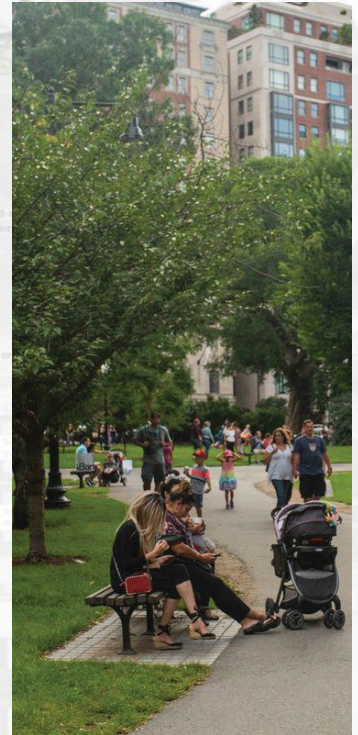

## EDUCATION

## RECREATION

## HEALTH & WELLBEING

## GREEN INFRASTRUCTURE

## URBAN CONNECTIVITY

HENSEL PARK

# MASTER PLAN

## LEGEND

- 1. Parking
- 1a. Parking (pervious)
- 2. Discovery Center
- 3. Commercial Buildings
- 4. Outdoor Classroom
- 5. Playground
- 6. Amphitheater
- 7. Open field
- 8. Dome Garden
- 9. Basketball Courts
- 10. Pickleball Courts
- 11. Bouldering Gym
- 12. Bird Screens
- 13. Detention Pond
- 14. Picnic Shelters
- 15. Bird Watching Tower
- 16. Hiking Trails
- 17. Resting Areas
- 18. Wildlife Habitats
- 19. Mountain Biking Trail



SCALE: 1" = 100' @ 48" x 36"





DISCOVERY CENTER

Food Truck Space

Intergenerational

- Amenities Include:
- Cafe/catering kitchen for various community events
  - Restroom facilities and storage space
  - Indoor and outdoor seating
  - Space to host foodtrucks
  - Classroom/event space

HENSEL PARK



Cafe/Catering Kitchen



Indoor/Outdoor Seating

2023.03  
06 | 40



Restroom Facilities

Entry Monument

South College Avenue

# VIEW OF DOME



Steel Grating

Dome Restoration Proposal

Gravelpave2  
(Both porous and ADA compliant)

# SITE PLAN ENLARGEMENT



## Rain Garden Plant List

- |   |   |
|---|---|
| <br><br><b>Red Yucca</b>              | <br><br><b>Texas Sedge</b>        |
| <br><br><b>New Gold Lantana</b>    | <br><br><b>Inland Sea Oats</b> |
| <br><br><b>Lindheimer's Muhly</b> | <br><br><b>Blue Flag Iris</b> |

# VIEW OF THE BIRD WATCH TOWER

HENSEL PARK



The incorporation of a bird watch tower on the north-east side of the park gives visitors the opportunity to observe the park's natural resources. The view towards the detention pond is a scenic view and a chance to see the bird migration in action during migration seasons.

# VIEWS OF THE DETENTION POND

A multi-use detention basin designated to hold run-off from the surrounding area during the raining season and a prairie during its off seasons.

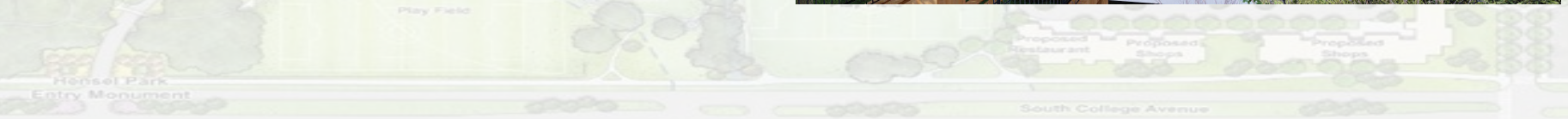
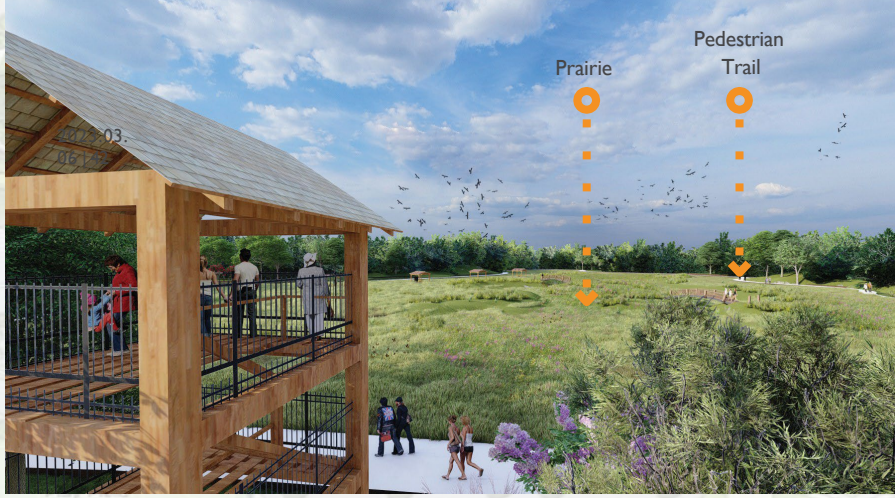
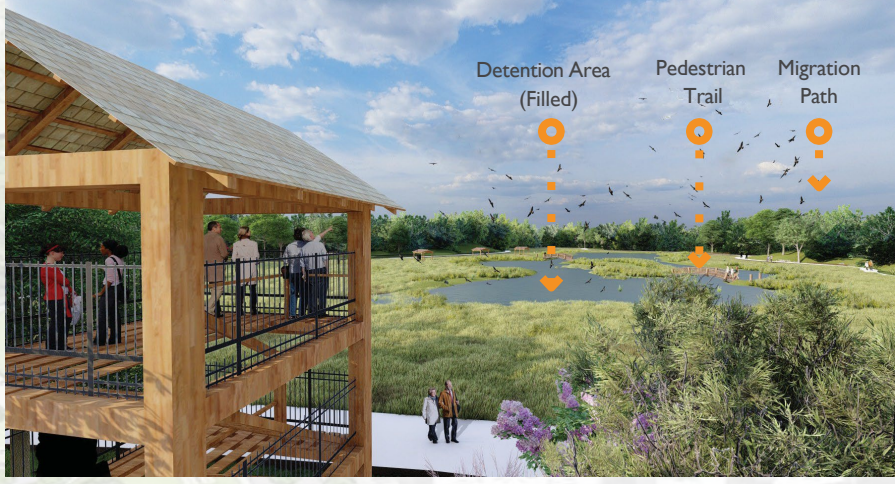

## VIEW OF WILDLIFE SHELTERS

### Bat Gardens and Houses

- Enhances Trails & Bat Population
- Increase Tree Canopy
- Allow Existing Brush to Remain
- Provides Food Source



### Bee Boxes and Colonies

- Adds Native Vegetation
- Enhances education on natural habitats
- Increases Bee Population



## VIEW OF TRAILS

### Bird Blinds and Education

- Repurposed Invasive Bamboo
- Educates the public on bird education
- Multi-use Trails



HENSEL PARK  
ENTRY MONUMENT

## SITE PLAN ENLARGEMENT



Hensel Park  
Entry Monument

South College Avenue

# VIEW OF CHICKADEE PLAYGROUND

HENSEL PARK

# SITE PLAN ENLARGEMENT



Chickadee playground is a natural play area that consists of wooden playground equipment that allows children to engage in more creative forms of play. The interactive taxonomy board shows the different bird species found in Hensel Park and introduces an educational aspect to the playground.



Hensel Park  
Entry Monument

Proposed  
Restaurant  
Proposed  
Shop  
Proposed  
Shop  
South College Avenue

# Hensel's Connection Park

**“Connecting People to a healthy lifestyle, nature and a sense of tranquility”**

Connect3

Kristopher Hunter, Zachary Garza, Mathew Martinez

Texas A&M University

College Station, Texas

LAND 412-April 24 2023

# Connect 3

## Team Members



**Kristopher Hunter**  
Fourth Year BLA  
Focus in Presentation  
Development and Research



**Mathew Martinez**  
Fourth Year BLA  
Focus in AutoCAD  
Documentation



**Zachary Garza**  
Fourth Year BLA  
Focus on Perspective  
Rendering

# Hensel Park Analysis

## Strengths

Hensel Park boasts several site strengths that make it a unique asset to the Bryan/College Station community. One of its most notable strengths is its natural vegetation, which includes a variety of trees, shrubs, and other plant life that provide shade, wildlife habitat, and aesthetic appeal. The park's open space is another strength, as it allows for a range of outdoor activities, from picnics and games to sports and events.

## Opportunities

Hensel Park has a strong sense of multi-generational community, with visitors of all ages regularly enjoying the park's natural beauty and outdoor activities. By designing proper amenities that cater to the needs and interests of all age groups, such as playgrounds, sports fields, walking trails, and picnic areas, the park can become an even more inclusive and welcoming space for the entire community.



## Weaknesses

Hensel Park in the Bryan/College Station area is **underutilized**, with many of its facilities and amenities not being used to their full potential. Additionally, the park is **undermaintained**, with trash often littering the grounds and basic upkeep and repairs not being performed. Finally, Hensel Park is **misused**, with some visitors engaging in activities that are not permitted.

## Threats

Hensel Park in College Station can be quite dangerous due to its **lack of maintenance**, as the park's weak trail system, playground equipment, and other amenities can pose hazards to visitors. The park's **lack of adequate lighting** also increases the risk of accidents to nearby residents/users.

# Hensel Park Design Strategies

Health



Walkability



Physical Exercise



Biking

Nature



Water



Plant Education



Using Nature for Rest

Tranquility



Art



Seating Around Park



Retail Rest Areas



**Legend**

- 1. Mountain Bike Trail
- 2. Sculpture Garden
- 3. Playground
- 4. Parkour Park
- 5. Rain Garden
- 6. Retention Pond
- 7. Retail Space
- 8. Parking
- 9. Disc Golf Course
- 10. New Roadway

1 inch = 100 feet



Hensel Park  
Entry Monument

South College Avenue

# Aerial View of Retail



Hensel Park  
Entry Monument

South College Avenue



# View of Entrance to Sculpture Garden

Sculpture

Existing Shape-lift Structure

Decomposed Granite

Lighting

Proposed Softscape

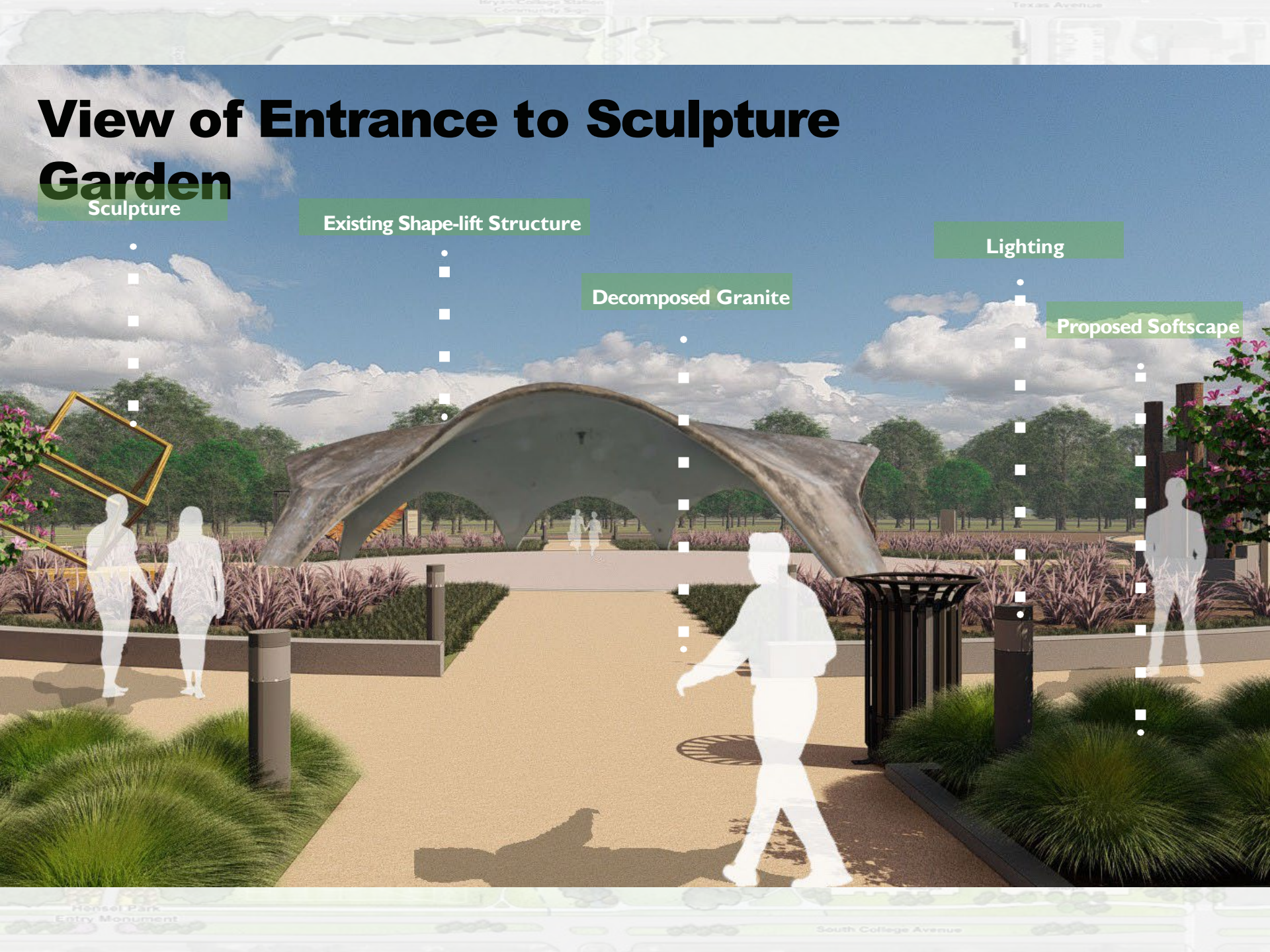



Future Intergenerational Living & Children's Learning Center

Future Intergenerational Living & Children's Learning Center

# Parkour Park



## Materials



Reclaimed Wood



Crushed Granite



Decomposed Granite

## Planting



Muhly



Crepe Myrtle



Mondo Grass



# Aerial View of Parkour Park

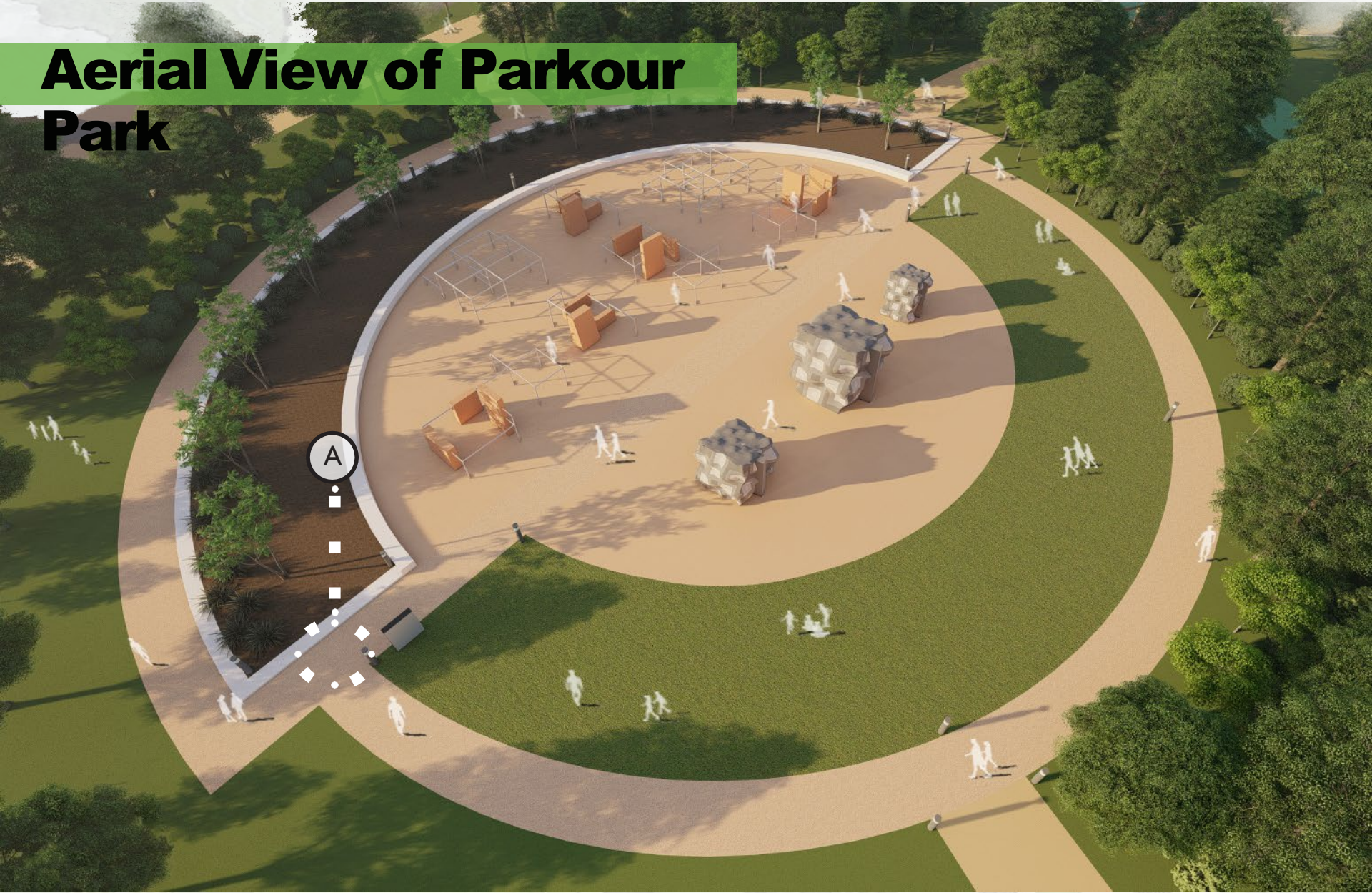

A

Hensel Park  
Entry Monument

South College Avenue

# View of Entrance Rain Garden

Proposed Softscape

Decomposed Granite

Open Grass Field

Landscaping Boulders

