

# ELEVATION CERTIFICATE

OMB No. 1660-0008  
Expires March 31, 2012

Important: Read the instructions on pages 1-9.

## SECTION A - PROPERTY INFORMATION

For Insurance Company Use:
Policy Number
Company NAIC Number

A1. Building Owner's Name Carlos Caballero

A2. Building Street Address (including Apt., Unit, Suite, and/or Bldg. No.) or P.O. Route and Box No.  
1501 Stallings Drive #61

City College Station State Tx ZIP Code 77840

A3. Property Description (Lot and Block Numbers, Tax Parcel Number, Legal Description, etc.)  
Sutters Mill Phase 2, Building K, Unit 61

A4. Building Use (e.g., Residential, Non-Residential, Addition, Accessory, etc.) Residential

A5. Latitude/Longitude: Lat. 30.6229N Long. 96.3152W Horizontal Datum: ☐ NAD 1927 ☐ NAD 1983

A6. Attach at least 2 photographs of the building if the Certificate is being used to obtain flood insurance.

A7. Building Diagram Number 1B

A8. For a building with a crawlspace or enclosure(s):

a) Square footage of crawlspace or enclosure(s) \_\_\_\_\_ sq ft

b) No. of permanent flood openings in the crawlspace or enclosure(s) within 1.0 foot above adjacent grade \_\_\_\_\_ sq in

c) Total net area of flood openings in A8.b \_\_\_\_\_ sq in

d) Engineered flood openings? ☐ Yes ☐ No

A9. For a building with an attached garage:

a) Square footage of attached garage \_\_\_\_\_ sq ft

b) No. of permanent flood openings in the attached garage within 1.0 foot above adjacent grade \_\_\_\_\_ sq in

c) Total net area of flood openings in A9.b \_\_\_\_\_ sq in

d) Engineered flood openings? ☐ Yes ☐ No

## SECTION B - FLOOD INSURANCE RATE MAP (FIRM) INFORMATION

B1. NFIP Community Name & Community Number <u>CITY OF COLLEGE STATION</u> <u>480083</u>	B2. County Name <u>BRAZOS</u>	B3. State <u>TX</u>			
B4. Map/Panel Number <u>48041C0144</u>	B5. Suffix <u>C</u>	B6. FIRM Index Date <u>7/2/1992</u>	B7. FIRM Panel Effective/Revised Date <u>7/2/1992</u>	B8. Flood Zone(s) <u>AE</u>	B9. Base Flood Elevation(s) (Zone AE, use base flood depth) <u>285.5</u>

B10. Indicate the source of the Base Flood Elevation (BFE) data or base flood depth entered in Item B9.

☐ FIS Profile ☐ FIRM ☐ Community Determined ☒ Other (Describe) LOMR, Case #00-06-175P, 7/10/2000

B11. Indicate elevation datum used for BFE in Item B9: ☒ NGVD 1929 ☐ NAVD 1988 ☐ Other (Describe) \_\_\_\_\_

B12. Is the building located in a Coastal Barrier Resources System (CBRS) area or Otherwise Protected Area (OPA)? ☐ Yes ☒ No

Designation Date \_\_\_\_\_ ☐ CBRS ☐ OPA

## SECTION C - BUILDING ELEVATION INFORMATION (SURVEY REQUIRED)

C1. Building elevations are based on: ☐ Construction Drawings\* ☐ Building Under Construction\* ☒ Finished Construction

\*A new Elevation Certificate will be required when construction of the building is complete.

C2. Elevations - Zones A1-A30, AE, AH, A (with BFE), VE, V1-V30, V (with BFE), AR, AR/A, AR/AE, AR/A1-A30, AR/AH, AR/AO. Complete Items C2.a-h below according to the building diagram specified in Item A7. Use the same datum as the BFE.

Benchmark Utilized City of CS Mon CS94-122 Vertical Datum NAVD88

Conversion/Comments Conversion from NAVD 88 to NGVD 29 is -.09 feet

Check the measurement used.

a) Top of bottom floor (including basement, crawlspace, or enclosure floor) 285.45 ☒ feet ☐ meters (Puerto Rico only)

b) Top of the next higher floor \_\_\_\_\_ ☐ feet ☐ meters (Puerto Rico only)

c) Bottom of the lowest horizontal structural member (V Zones only) \_\_\_\_\_ ☐ feet ☐ meters (Puerto Rico only)

d) Attached garage (top of slab) \_\_\_\_\_ ☐ feet ☐ meters (Puerto Rico only)

e) Lowest elevation of machinery or equipment servicing the building 284.43 ☒ feet ☐ meters (Puerto Rico only)

(Describe type of equipment and location in Comments)

f) Lowest adjacent (finished) grade next to building (LAG) 283.78 ☒ feet ☐ meters (Puerto Rico only)

g) Highest adjacent (finished) grade next to building (HAG) 285.24 ☒ feet ☐ meters (Puerto Rico only)

h) Lowest adjacent grade at lowest elevation of deck or stairs, including structural support \_\_\_\_\_ ☐ feet ☐ meters (Puerto Rico only)

## SECTION D - SURVEYOR, ENGINEER, OR ARCHITECT CERTIFICATION

This certification is to be signed and sealed by a land surveyor, engineer, or architect authorized by law to certify elevation information. I certify that the information on this Certificate represents my best efforts to interpret the data available. I understand that any false statement may be punishable by fine or imprisonment under 18 U.S. Code, Section 1001. ☐

Check here if comments are provided on back of form. Were latitude and longitude in Section A provided by a licensed land surveyor? ☒ Yes ☐ No

Certifier's Name MICHAEL CUZZO

License Number 5693

Title Registered Professional Land Surveyor Company Name GOODWIN-LASITER, INC.

Address 3600 STATE HWY 6 S., STE 102 City COLLEGE STATION State TX ZIP Code 77845

Signature Michael Cuzzo Date 3/9/2012 Telephone 979/696-6767

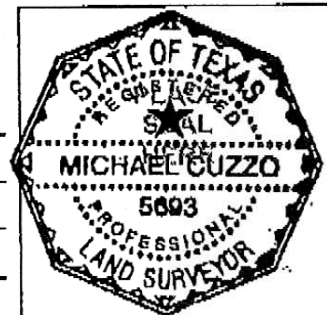

**IMPORTANT: In these spaces, copy the corresponding information from Section A.**

Building Street Address (including Apt., Unit, Suite, and/or Bldg. No.) or P.O. Route and Box No.

1501 Stallings Drive #61

City College Station State Tx ZIP Code 77840

Form Number: 81-31

Page Number: 1

Company Name: N/A

### SECTION D - SURVEYOR, ENGINEER, OR ARCHITECT CERTIFICATION (CONTINUED)

Copy both sides of this Elevation Certificate for (1) community official, (2) insurance agent/company, and (3) building owner.

Comments

Signature

Date

☐ Check here if attachments

### SECTION E - BUILDING ELEVATION INFORMATION (SURVEY NOT REQUIRED) FOR ZONE AO AND ZONE A (WITHOUT BFE)

For Zones AO and A (without BFE), complete Items E1-E5. If the Certificate is intended to support a LOMA or LOMR-F request, complete Sections A, B, and C. For Items E1-E4, use natural grade, if available. Check the measurement used. In Puerto Rico only, enter meters.

E1. Provide elevation information for the following and check the appropriate boxes to show whether the elevation is above or below the highest adjacent grade (HAG) and the lowest adjacent grade (LAG).

a) Top of bottom floor (including basement, crawlspace, or enclosure) is \_\_\_\_\_ ☐ feet ☐ meters ☐ above or ☐ below the HAG.

b) Top of bottom floor (including basement, crawlspace, or enclosure) is \_\_\_\_\_ ☐ feet ☐ meters ☐ above or ☐ below the LAG.

E2. For Building Diagrams 6-9 with permanent flood openings provided in Section A Items 8 and/or 9 (see pages 8-9 of Instructions), the next higher floor (elevation C2.b in the diagrams) of the building is \_\_\_\_\_ ☐ feet ☐ meters ☐ above or ☐ below the HAG.

E3. Attached garage (top of slab) is \_\_\_\_\_ ☐ feet ☐ meters ☐ above or ☐ below the HAG.

E4. Top of platform of machinery and/or equipment servicing the building is \_\_\_\_\_ ☐ feet ☐ meters ☐ above or ☐ below the HAG.

E5. Zone AO only: If no flood depth number is available, is the top of the bottom floor elevated in accordance with the community's floodplain management ordinance? ☐ Yes ☐ No ☐ Unknown. The local official must certify this information in Section G.

### SECTION F - PROPERTY OWNER (OR OWNER'S REPRESENTATIVE) CERTIFICATION

The property owner or owner's authorized representative who completes Sections A, B, and E for Zone A (without a FEMA-issued or community-issued BFE) or Zone AO must sign here. The statements in Sections A, B, and E are correct to the best of my knowledge.

Property Owner's or Owner's Authorized Representative's Name

Address

City

State

ZIP Code

Signature

Date

Telephone

Comments

☐ Check here if attachments

### SECTION G - COMMUNITY INFORMATION (OPTIONAL)

The local official who is authorized by law or ordinance to administer the community's floodplain management ordinance can complete Sections A, B, C (or E), and G of this Elevation Certificate. Complete the applicable item(s) and sign below. Check the measurement used in Items G8 and G9.

G1. ☐ The information in Section C was taken from other documentation that has been signed and sealed by a licensed surveyor, engineer, or architect who is authorized by law to certify elevation information. (Indicate the source and date of the elevation data in the Comments area below.)

G2. ☐ A community official completed Section E for a building located in Zone A (without a FEMA-issued or community-issued BFE) or Zone AO.

G3. ☐ The following information (Items G4-G9) is provided for community floodplain management purposes.

G4. Permit Number

G5. Date Permit Issued

G6. Date Certificate Of Compliance/Occupancy Issued

G7. This permit has been issued for: ☐ New Construction ☐ Substantial Improvement

G8. Elevation of as-built lowest floor (including basement) of the building: \_\_\_\_\_ ☐ feet ☐ meters (PR) Datum \_\_\_\_\_

G9. BFE or (in Zone AO) depth of flooding at the building site: \_\_\_\_\_ ☐ feet ☐ meters (PR) Datum \_\_\_\_\_

G10. Community's design flood elevation \_\_\_\_\_ ☐ feet ☐ meters (PR) Datum \_\_\_\_\_

Local Official's Name

Title

Community Name

Telephone

Signature

Date

Comments

☐ Check here if attachments